

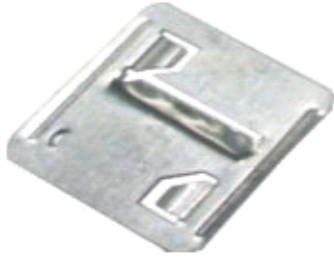

Interior Wall Panel Installation

1. Accsories and fittings:



Zncification Clips



Zncification Clips(Side)



Aluminum Keel

□ Metal keel design

Considering the strength and the convinent,Mexytech company develop the Zincification metal keel and Fastener,which can be used on both the interior wall panel & ceiling series.the standard lenth of matel keel is 3 meters one squaremeter wall panel needs about 1.8 meters,and 20 sets of fastener.

□ Installation :

- 1.Fix the keel on the wall with the expansion screw.
- 2.Make sure the keels are level and vertical.
- 3.Install the fastener on the keel.
- 4.Adjust the position of the fastener,fix the wall panel.
- 5.Completion.

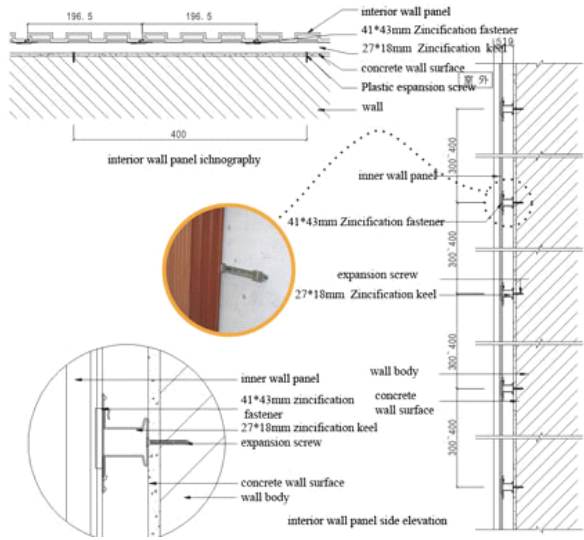

Horizontal Installation

线条3明角收口完成图



Vertical Installation

纵向安装明角碰口完成图